

CBH16/CBD16 Electric Pallet Truck



Product Characteristics

- ◆ 750W DC permanent magnet drive motor, strong power and longer life;
- ◆ Brand-new integral frame, the whole vehicle covering parts are sheet metal parts, which are more anti-collision and not easy to be deformed;
- ◆ Standard Curtis controller, stable performance and easy maintenance;
- ◆ Equipped with balance wheels as standard on both sides of the frame, and covered with fully enclosed sheet metal parts to improve the stability and safety of the whole vehicle;
- ◆ The whole vehicle adopts high-strength polyurethane wheels to make it more wear-resistant;
- ◆ Lithium iron phosphate battery, portable lithium battery pack, plug-in structure, stable and safe quality, easy and quick replacement;
- ◆ The handle accords with the principle of ergonomics, integrated design, integrated key switch, electricity meter, comes with emergency reverse function, the device is easy to operate and safe to use;
- ◆ Free to choose semi-electric models;

CBH16/CBD16 Electric pallet truck performance parameters

Manufacturer's type designation	HOPPER			
Model			CBH16	CBD16
Power type			Electric	Electric
Type of operation			Pedestrian	Pedestrian
Load capacity/rated load		t	1.6	1.6
Load center distance		mm	600	600
Total weight(with lithium battery)		kg	145/150	155/160
Driving wheel size		mm	φ 210x70	φ 210x70
Tyre size (Front)		mm	φ 80x70	φ 80x70
Wheels material			PU coated iron core	PU coated iron core
Overall length	L1	mm	1540	1540
Overall width	B	mm	560/680	560/680
Height of operating Handlebar(Max)	H3	mm	1220	1220
Frame height	H4	mm	560	560
Lifting height(Max)	H1	mm	190	190
Lifting height(Min)	H	mm	85	85
Fork length	L	mm	1150	1150
Fork Dimension	B1	mm	160	160
Turning radius	R	mm	1350	1350
Center distance between front and rear wheels	L2	mm	1220	1220
Traveling speed(laden/ unladen)		km/h	4.5	4.5
Max. Gradeability (laden/unladen)		%	3/5	3/5
Drive motor rating		kw	0.75	0.75
Lift motor rating		kw	/	0.5
Battery voltage/capacity		V/Ah	24/20	24/20

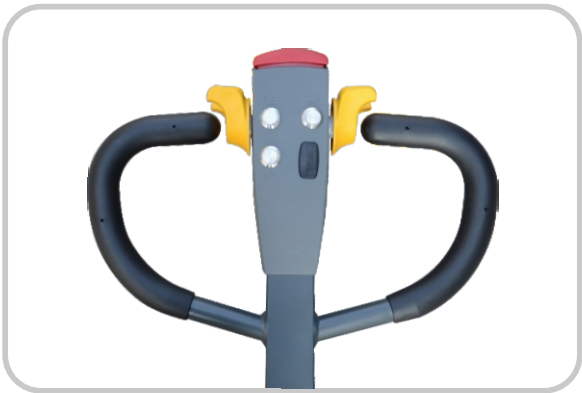

Standard



Ergonomically designed smart handle (optional)
Smooth operation and flexible steering

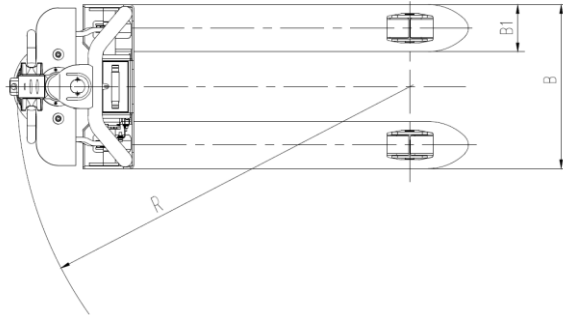
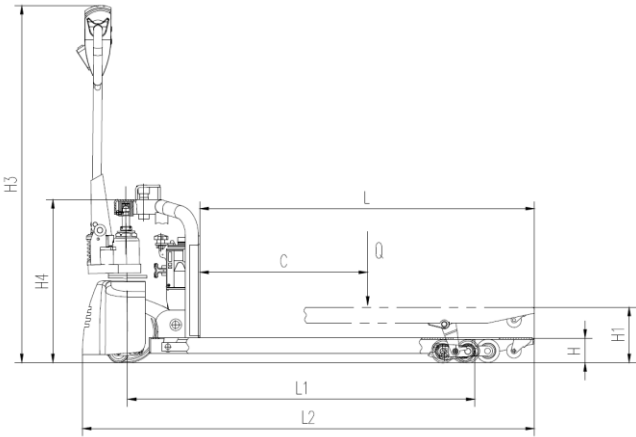

CBD20 Electric Pallet Truck



Product Characteristics

- ◆ High-quality hydraulic power unit, low noise, low vibration, strong sealing, the lifting speed can be adjusted according to the actual use environment, to ensure that the lifting speed is stable and reliable;
- ◆ Precise electrical limit switch, accurately control the maximum lifting height, prevent damage to the motor;
- ◆ The mechanized design of the control handle makes it convenient for left and right hand operations, simple operation, and improved driving comfort. The handle is equipped with an emergency reverse switch, which makes the whole operation safer;
- ◆ Electronic steering system, easier operation, more flexible steering, emergency reverse driving switch;
- ◆ The drive motor adopts an AC motor, which is maintenance-free, has a long life, has a re-brake function and a slope suppression function, and has excellent driving control;
- ◆ No level to control the driving speed, and meet different driver rhythm;
- ◆ Low-voltage protection system extends the service life of the battery;
- ◆ The turning radius is small and the vehicle can pass through well;
- ◆ The user stands-on-driving operation, the stand-on pedal has a good shock-absorbing effect, is comfortable to operate, and is not easy to fatigue. With arm guards on both sides, the driving operation is easy, convenient, good visibility, and safe operation;
- ◆ This vehicle is equipped with a high-performance multi-function meter, which has a power display and a cumulative operating time display. This meter has extremely high reliability even in extremely harsh environments;
- ◆ The integrated electrical system layout, the wiring is neat, clear, easy to overhaul, and the electrical system is reliable and shockproof.

CBD20

Electric pallet truck performance parameters

Identification	1.1	Manufacturer's type designation	HOPPER		
	1.2	Model			CBD20
	1.3	Power Type			Electric
	1.4	Type of operation			Stand-on
	1.5	Steering Mode			Electric Power Steering
	1.6	Load capacity/rated load	Q	kg	2000
	1.7	Load center distance	C	mm	600
	1.8	Wheelbase	y	mm	1400
Weight	2.1	Total Weight(with battery)		kg	585
	2.2	AxleLoad(laden):Drive side/Load-bearing side		kg	885/1700
	2.3	AxleLoad(unladen):Drive side/Load-bearing side		kg	490/95
Dimension	3.1	Overall Length(Pedal retracted/expanded)	L1/L2	mm	1850/2265
	3.2	Overall Width	W1	mm	720
	3.3	Fork Dimension	l/e/s	mm	1200×160×50
	3.4	Width of Fork	b2	mm	540/685
	3.5	Min.Fork Height	h3	mm	85
	3.6	Lift Height	h2	mm	195
	3.7	Ground Clearance at center of wheelbase	m1	mm	35
	3.8	Height of Operating Handlebar(Min./Max)	h14	mm	1000/1450
	3.9	Turning Radius(Pedal retracted/expanded)	Wa	mm	1675/2110
	3.10	Aisle width for lengthways(Palletsize1000*1200)(Pedal retracted/expanded)	Ast	mm	2410/2845
	3.11	Aisle width for lengthways(Pallet size 800*1200)(Pedal retracted/expanded)	Ast	mm	2320/2755
Tyre	4.1	Tyre Type			Polyurethane
	4.2	Tyre Size(Front)		mm	φ80x60
	4.3	Tyre Size(Auxiliary wheel)		mm	φ115x55
	4.4	Tyre Size(Driving Wheel)		mm	φ230x75
	4.5	Wheels Quantity, front/rear (x=driving wheels)			4/1x+1
Performance	5.1	Drive Damping Method			/
	5.2	Traveling Speed(laden/unladen)		Km/h	6/6
	5.3	Lifting Speed(laden/unladen)		mm/s	20/25
	5.4	Lowering Speed(laden/unladen)		mm/s	30/26
	5.5	Max.Gradient performance(laden/unladen)		%	5/10
	5.6	Service Brake Type			Electromagnetic/regeneration
	5.7	Parking Brake Type			Electromagnetic
Power Unit	6.1	Drive Motor rating(AC) S2-60min		kW	1.2
	6.2	Lift Motor rating(DC) S3-15%		kW	0.8
	6.3	Battery Voltage/Capacity K5		V/Ah	24/210
	6.4	Battery Weight		kg	188
Others	7.1	Controller Brand			ZAPI
	7.2	Controller Model			AC-0
	7.3	Sound level at driver's ear according to EN 12 053		dB	70

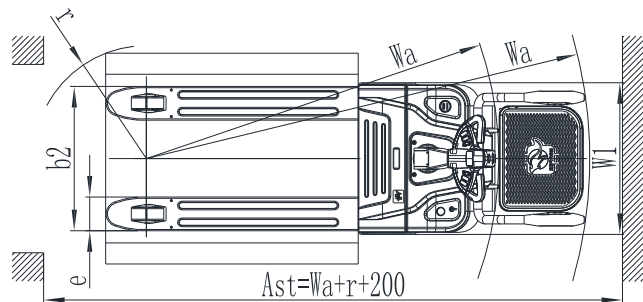
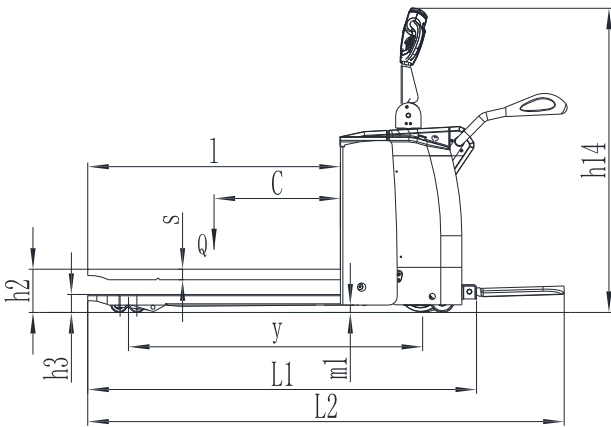

CBD25 Electric Pallet Truck



Product Characteristics

- ◆ The driving suspension mechanism has good stability;
- ◆ The battery can be pulled sideways and can be hoisted, which is beneficial for battery interchange and maintenance;
- ◆ High-quality hydraulic power unit, low noise, low vibration, strong sealing, the lifting speed can be adjusted according to the actual use environment, to ensure that the lifting speed is stable and reliable;
- ◆ Precise electrical limit switch, accurately control the maximum lifting height, prevent damage to the motor;
- ◆ The mechanized design of the control handle makes it convenient for left and right hand operations, simple operation, and improved driving comfort. The handle is equipped with an emergency reverse switch, which makes the operation of the whole vehicle safer;
- ◆ Electronic steering system, easier operation, more flexible steering, emergency reverse driving switch;
- ◆ The horizontal AC drive facilitates the maintenance of the motor and the brake, and improves the reliability and service life of the brake;
- ◆ No level control of driving speed, to meet the rhythm of different drivers;
- ◆ Low-voltage protection system extends the service life of the battery;
- ◆ The user stands-on-driving operation, the stand-on pedal has a good shock-absorbing effect, is comfortable to operate, and is not easy to fatigue. With arm guards on both sides, the driving operation is easy, convenient, good visibility, and safe operation;
- ◆ This car is equipped with a high-performance multi-function meter, which has a power display and a cumulative operating time display. This meter has extremely high reliability even in extremely harsh environments.
- ◆ Integrated electrical system layout, neat and clear wiring, easy maintenance, reliable electrical system and shockproof.

CBD25

Electric pallet truck performance parameters

Identification	1.1	Manufacturer's type designation	HOPPER		
	1.2	Model			CBD25
	1.3	Power Type			Electric
	1.4	Type of operation			Stand-on
	1.5	Steering Mode			Electric Power Steering
	1.6	Load capacity/rated load	Q	kg	2500
	1.7	Load center distance	C	mm	600
	1.8	Wheelbase	y	mm	1480
Weight	2.1	Total Weight(with battery)		kg	790
	2.2	Axle Load(laden):Drive side/Load-bearing side		kg	1120/2170
	2.3	Axle Load(unladen):Drive side/Load-bearing side		kg	660/130
Dimension	3.1	Overall Length(Pedal retracted/expanded)	L1/L2	mm	1885/2300
	3.2	Overall Width	W1	mm	790
	3.3	Fork Dimension	l/e/s	mm	1220×185×50
	3.4	Width of Fork	b2	mm	550/685
	3.5	Min.Fork Height	h3	mm	85
	3.6	Lift Height	h2	mm	205
	3.7	Ground Clearance at center of wheelbase	m1	mm	45
	3.8	Height of Operating Handlebar(Min./Max)	h14	mm	1000/1450
	3.9	Turning Radius(Pedal retracted/expanded)	Wa	mm	1665/2150
	3.10	Aisle width for lengthways(Pallet size 1000*1200)(Pedal retracted/expanded)	Ast	mm	2410/2900
	3.11	Aisle width for lengthways(Pallet size 800*1200)(Pedal retracted/expanded)	Ast	mm	2320/2800
Tyre	4.1	Tyre Type			Polyurethane
	4.2	Tyre Size(Front)		mm	Φ80x80
	4.3	Tyre Size(Auxiliary wheel)		mm	Φ115x55
	4.4	Tyre Size(Driving Wheel)		mm	Φ230x75
	4.5	Wheels Quantity, front/rear (x=driving wheels)			4/1x+2
Performance	5.1	Drive Damping Method			Guide column spring damping
	5.2	Traveling Speed(laden/unladen)		Km/h	6/6
	5.3	Lifting Speed(laden/unladen)		mm/s	20/25
	5.4	Lowering Speed(laden/unladen)		mm/s	30/26
	5.5	Max.Gradient performance(laden/unladen)		%	5/8
	5.6	Service Brake Type			Electromagnetic/regeneration
	5.7	Parking Brake Type			Electromagnetic
Power Unit	6.1	Drive Motor rating(AC) S2-60min		kW	1.5
	6.2	Lift Motor rating(DC) S3-15%		kW	2.2
	6.3	Battery Voltage/Capacity K5		V/Ah	24/210
	6.4	Battery Weight		kg	188
Others	7.1	Controller Brand			CURTIS
	7.2	Controller Model			1232E
	7.3	Sound level at driver's ear according to EN 12 053		dB	70

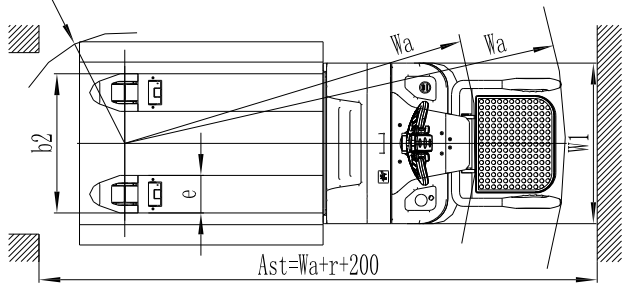
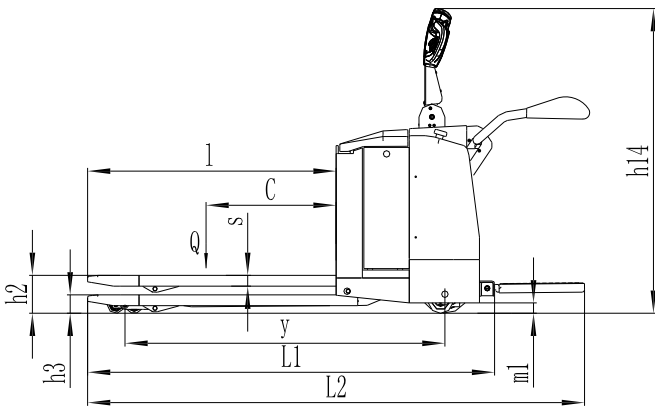

CBD20M/25M/30M Electric Pallet Truck



Product Characteristics

- ◆ Maintenance-free AC drive system, more rapid and accurate response, 8km/h high speed, and the high-quality PU drive wheels to ensure life time;
- ◆ Curtis controller, stable and safer performance, AMP waterproof plug-in, greatly reducing the electrical failure rate;
- ◆ The double auxiliary wheels are arranged on both sides of the driving wheels, and turning automatically decelerates, more safe and stable driving;
- ◆ Electromagnetic brake, automatic brake when power off, to ensure that it will not slip when parked;
- ◆ Concealed damper pedal design, high comfort when driving, better passability when folding, and achieve a smaller turning radius in the same industrial field;
- ◆ The drive wheel with float shock absorption design, reduce body vibration, better passability, suitable for various working conditions;
- ◆ The new lever-type lifting mechanism design, withstand shock and higher structural stability;

Optional Accessories

- Password lock- Can enter the password manually or start by card, greatly simplifies the process of authorizing operations, especially for multiple people to operate the vehicle;
- Side-pulling batteries- High efficient battery replacement through the special trailer, to make operator that operate the vehicle in multiple shifts;
- Equipped with an automatic liquid filling system, to quickly replenish the lead-acid for battery.
- Large-capacity battery, Max.300AH, Increase the demand for work that can meet the long-term time;
- Lithium battery can be selected and with Fast charge, maintenance-free, environmentally friendly and intelligent display.
- Extended fork- to meet customer's different demands.

CBD20M/25M/30M

Electric pallet truck performance parameters

Identification	1.1	Manufacturer's type designation			HOPPER		
	1.2	Model			CBD20M	CBD25M	CBD30M
	1.3	Power Type			Electric		
	1.4	Type of operation			Stand-on		
	1.5	Steering Mode			Electric Power Steering		
	1.6	Load capacity/rated load	Q	kg	2000	2500	3000
	1.7	Load center distance	C	mm	600	600	600
	1.8	Wheelbase	y	mm	1410	1410	1410
Weight	2.1	Total Weight(with battery)		kg	650	650	670
	2.2	Axle Load(laden):Drive side/Load-bearing side		kg	900/1750	1070/2080	1245/2425
	2.3	Axle Load(unladen):Drive side/Load-bearing side		kg	545/105	545/105	560/110
Dimension	3.1	Overall Length(Pedal retracted/expanded)	L1/L2	mm	1800/2265	1800/2265	1800/2265
	3.2	Overall Width	W1	mm	810	810	810
	3.3	Fork Dimension	l/e/s	mm	1150×170×55	1150×170×55	1150×170×55
	3.4	Width of Fork	b2	mm	535/685	535/685	535/685
	3.5	Min.Fork Height	h3	mm	85	85	85
	3.6	Lift Height	h2	mm	205	205	205
	3.7	Ground Clearance at center of wheelbase	m1	mm	55	55	55
	3.8	Height of Operating Handlebar(Min./Max)	h14	mm	1000/1380	1000/1380	1000/1380
	3.9	Turning Radius(Pedal retracted/expanded)	Wa	mm	1660/2100	1660/2100	1660/2100
	3.10	Aisle width for lengthways(Pallet size 1000*1200)(Pedal retracted/expanded)	Ast	mm	2400/2840	2400/2840	2400/2840
	3.11	Aisle width for lengthways(Pallet size 800*1200)(Pedal retracted/expanded)	Ast	mm	2315/2755	2315/2755	2315/2755
Tyre	4.1	Tyre Type			Polyurethane	Polyurethane	Polyurethane
	4.2	Tyre Size(Front)		mm	φ85x70	φ85x70	φ85x70
	4.3	Tyre Size(Auxiliary wheel)		mm	φ115x55	φ115x55	φ115x55
	4.4	Tyre Size(Driving Wheel)		mm	φ230x75	φ230x75	φ230x75
	4.5	Wheels Quantity, front/rear (x=driving wheels)			4/1x+2	4/1x+2	4/1x+2
Performance	5.1	Drive Damping Method			Drive frame integral guide rail spring damping		
	5.2	Traveling Speed(laden/unladen)		Km/h	7.5/8	6.0/7	5.0/7
	5.3	Lifting Speed(laden/unladen)		mm/s	22/35	22/30	22/30
	5.4	Lowering Speed(laden/unladen)		mm/s	30/26	30/26	30/26
	5.5	Max.Gradient performance(laden/unladen)		%	8/15	8/15	6/15
	5.6	Service Brake Type			Electromagnetic/regeneration		
	5.7	Parking Brake Type			Electromagnetic		
Power Unit	6.1	Drive Motor rating(AC) S2-60min		kW	1.5	1.5	1.5
	6.2	Lift Motor rating(DC) S3-15%		kW	0.8	0.8	2.2
	6.3	Battery Voltage/Capacity K5		V/Ah	24/210	24/210	24/240
	6.4	Battery Weight		kg	188	188	210
Others	7.1	Controller Brand			CURTIS	CURTIS	CURTIS
	7.2	Controller Model			1232E	1232E	1232E
	7.3	Sound level at driver's ear according to EN 12 053		dB	70	70	70

